

NEW

# COMMERCIAL SSG SERIES



*"America's Door"*



**Mid-America Door®**

MIDAMERICADOOR.COM

# Introducing the New COMMERCIAL SSG SERIES

Mid-America Door's new SSG Series features our beautiful Micro Groove design, along with the strength and durability of steel. The SSG may also be used with wood or steel jambs, which add strong functionality to any specification.

## STANDARDS

**Reverse Angle:** Door overlaps jamb approximately 1" against continuous angle of track support system (angle foot toward door). May be used with wood or steel jambs. The door closes against the base flange of the continuous angle.

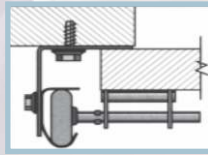

**Bracket Mounted Track:** Use with wood jambs. Door closes against top molding.



**General:** SSG specs are similar to SSI and Full View Series, as manufactured by Mid-America Door Co.

**Related Work:** Opening preparation, miscellaneous or structural metal work, access panels, finish or field painting, are in the scope of work of other trades.

**Door Sections:** Sections feature nominal 2" thickness, manufactured using exterior roll-formed 25 gauge steel (as SSI-25). SSG has continuous sculpted polystyrene board bonded between the exterior steel face and flush embossed steel interior. Sections will have a tongue and groove meeting rail to provide a weather tight seal between sections. End stiles will be 18 gauge galvanized formed steel. Center stiles will be vertical interior 16 gauge steel plates running the entire section height placed on centers for design requirements. Door sections to have a calculated R factor of 9.4.

**Track:** Galvanized steel track systems are 2" or 3" depending upon door size and will be bracket or angle mounted, depending upon application.

**Hardware:** Hinges and brackets to be made from galvanized steel. Each roller has ten hardened 1/4" steel balls per roller, or adequate for design requirements. Cables are 7 x 19 strand galvanized aircraft type with a minimum safety factor of 8 to 1.

**Spring Counterbalance:** Springs shall be oil tempered, helical wound and stress relieved torsion type. Springs shall be mounted on a continuous cross header steel shaft support by bearing brackets. Long life springs of 25-50-100 thousand cycles may be specific and are recommended for high uses.

**Finish:** Paint will be backed on commercial white with a polyester coating.

**Weather-Strip:** Bottom rail of section to include U-shaped vinyl astragal held in place by aluminum retainer to provide additional reinforcement. Additional weather-stripping available for full width of header and jambs.

**Lock:** Lock will be interior mount slide lock. (Optional cylinder lock available.)

**Vision Sections:** 6 x 24 and 12 x 24 vinyl frame lites can be provided in either single glaze or double glaze. Also available with Full View sections.

**Operation:** Operation to be made by manual lift, chain or electric motor.

## Available Colors



Please see your Mid-America Door distributor for an exact color sample.

## Steel Door Panel & Selection Schedule

SSG series			Sections High	
Width	Panels Wide	Number Stiles	Height	Number of Sections
Thru 9' 2"	2	1	Thru 8'	4
9' 3" - 12' 2"	3	2	8' 3" - 10' 0"	5
12' 3" - 16' 2"	4	3	10' 3" - 12' 0"	6
16' 3" - 18' 2"	5	4	12' 3" - 14' 0"	7
			14' 3" - 16' 0"	8

## Clearance & Mounting Requirements

	Clear Headroom		Sideroom		Depth Into Room		Depth Into Room	
	2" Track	3" Track	2" Track	3" Track	2 & 3" Track	2" Track	3" Track	
Standard Lift Manual 12"	12½"	21"	4½"	5½"	Door Height + 18"	Door Height + 13½"	Door Height + 15½"	
Standard Lift Motor Operated	19"	21½"						
Standard Lift Manual 15"	16½"	21"	4½"	5½"	Door Height + 18"	Door Height + 13½"	Door Height + 15½"	
Standard Lift Motor Operated	19"	22½"						
High Lift Manual	High Lift + 12"		4½"	5½"	Door Height Less Lift + 30"	Door Height + Lift + 6½"	Door Height + Lift + 7½"	
High Lift Motor Operated	High Lift + 12"		24" One Side		Door Height Less Lift + 30"	Double Door Height + 2"		
Vertical Lift Manual	Door Height + 18"		4½"	5½"	18"	Double Door Height + 2"		
Vertical Lift Motor Operated			24" One Side		18"			
Low Headroom Manual	2" Track				3" Track			
Headroom Requirements (Add 4" for Operator)	Drum	Front Torsion	Rear Torsion	Drum	Front Torsion	Rear Torsion		
	4 - 8	11"	6"	4 - 8	12"	8"		
	4 - 12	11"	6"	4 - 12	12"	8"		
	5 - 18	13"	8"	5 - 18	14"	10"		
	800 - 32	16"	11"	800 - 32	17"	13"		

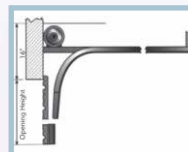

Standard Headroom

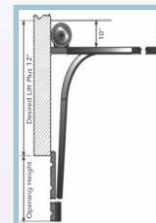

High Lift

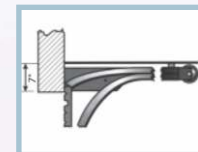

Low Headroom

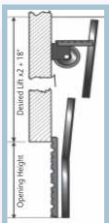

Vertical Lift



**Mid-America Door®**

MidAmericaDoor.com - 1001 West Hartford - Ponca City, OK 74601 - (800) 364-3667

